



## Quick-Start Installation Guide

### ALEXOR Wireless Panel & WT5500 Keypad



Just a few short steps will help you simplify your installation process & get you on your way to your next install



#### 1. Remove Face Plate from ALEXOR Wireless Panel

To remove the face plate, insert a small screwdriver into the 2 slots located at the bottom.



#### 2. Run the Power

Run AC wire and phone line through wire channel, into ALEXOR casing and wire into terminal blocks as indicated.

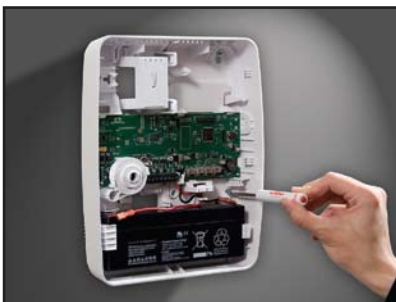

#### 3. Attach the Panel Cabinet

Mark mounting holes on wall and mount with screws provided.



#### 4. Connect the Battery and Power It Up

Connect battery and connect face to back plate.  
Provide AC to ALEXOR by plugging in the transformer



## Quick-Start Installation Guide

### ALEXOR Wireless Panel & WT5500 Keypad



#### 5. Power Up the WT5500 Keypad

Remove the mounting bracket from the keypad and insert batteries.



#### 6. Enroll the Keypad and Wireless Devices into the Panel

Press star (\*) and 1 to enroll. This must take place within the first two minutes of powering up ALEXOR. Keypad will display "WFKP Enrollment Successful" message. To enroll wireless devices, use the quick enroll feature found within installers programming section [898].

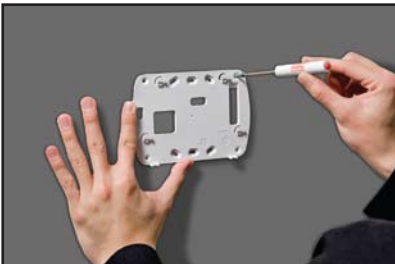

#### 7. Mount the Keypad onto the Wall

Using the screws provided, mount the keypad bracket onto the wall. Set keypad onto the wall bracket and snap into place.



#### 8. Program ALEXOR

Perform template programming found in section [899]. Enter the 4 digit code which represents the functions required for basic operation through template programming. Code prompts exist for pre-defined zone definitions, reporting code formats, communication call directions, and DLS setup. Once all codes have been programmed, you will be prompted to enter the monitoring station phone number and account code, DLS access code, entry and exit delays, and installer code.



#### 9. Perform Placement Testing

The proposed placement of each wireless device should be tested before it is mounted by entering section [904]-[906]. Testing the signal strength between ALEXOR and wireless devices can be accomplished in a group (global placement test) or individually.

Installation Complete!